



at&t

User's manual

TL80133

Cordless Accessory Speakerphone
for use with many AT&T business
phones and AT&T CL, CRL, CLP, TL
and VTech DS, SN, IS series home
cordless phones



Congratulations

on your purchase of this AT&T product.

Be more mobile by using the AT&T TL80133 DECT 6.0 cordless accessory speakerphone for everyday conversations. Plus, the speakerphone fits easily in your hand or a pocket, making it easy to stay connected as you go about your day. Enjoy a sound that can keep up with your calls. Increase participation by allowing both ends to speak—and to be heard—at the same time, for conversations that are more true to life. With up to 500 feet of range, you will experience the best in long-range coverage and clarity.

Before using this AT&T product, please read **Important safety information** on pages 30-33 of this manual. Please thoroughly read this user's manual for all the feature operations and troubleshooting information necessary to install and operate your new AT&T product. You can also visit our website at **www.telephones.att.com** or call **1 (800) 222-3111**. In Canada, dial **1 (866) 288-4268**.

Visit **www.telephones.att.com** for a complete list of phones that have been tested and found to be compatible with the TL80133.

This telephone meets the California Energy Commission regulations for energy consumption. Your telephone is set up to comply with the energy-conserving standards right out of the box. No further action is necessary.

Model number: TL80133

Type: Cordless Accessory Speakerphone

Serial number: _____

Purchase date: _____

Place of purchase: _____

Both the model and serial numbers of your AT&T product can be found on the bottom of the speakerphone charger.

Save your sales receipt and original packaging in case it is necessary to return your telephone for warranty service.

Parts checklist

Check to make sure the package includes the following items. Save your sales receipt and original packaging in the event warranty service is necessary.

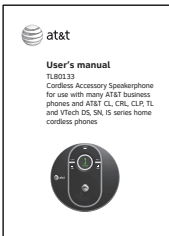

User's manual



Cordless speakerphone



Speakerphone charger



Power adapter for speakerphone charger



Battery for cordless speakerphone



Battery compartment cover

User's manual

TL80133

Cordless accessory speakerphone for use with many AT&T business phones and AT&T CL, CRL, CLP, TL and VTech DS, SN, IS series home cordless phones



Table of contents

Getting started

Installation.....	1
Charger installation.....	2
Battery installation and charging.....	3
Adding and registering a speakerphone	5
Register a speakerphone to a telephone base.....	5
Replacing a speakerphone	8
Deregister all speakerphones.....	8
Quick reference guide - speakerphone	9
Speakerphone lights	10
Speakerphone alert tones	11
Speakerphone voice prompts	12

Operation

Speakerphone operation	13
Make a call.....	13
Answer a call.....	13
End a call.....	13
Auto-off	14

Speakerphone ringer	15
Temporary ringer silencing	15
Speakerphone paging	16
Options while on calls.....	17
Volume control	17
Mute	17
Flash/call waiting.....	18
Join a call in progress.....	19
Intercom.....	20
Intercom calls and transfers	20
Answer an incoming call during an intercom call....	21

Appendix

Troubleshooting	22
Important safety information.....	30
Safety information.....	30
Especially about cordless speakerphones...	31
Precautions for users of implanted cardiac pacemakers	33
Pacemaker patients.....	33

Maintenance.....	34
FCC, ACTA and IC regulations	35
California Energy Commission battery charging testing instructions.....	40
Limited warranty.....	41
Technical specifications	45
DECT 6.0 digital technology	45
Operating range.....	45
Simulated full-duplex speakerphone.....	45
Extended range and clarity.....	46
Index	
Index.....	47

Getting started
Installation

You must install and charge the battery before using the speakerphone.



See pages 3-4 for easy instructions.

For customer service or product information, visit our website at **www.telephones.att.com** or call **1 (800) 222-3111**.
In Canada, dial **1 (866) 288-4268**.

Charger installation

Install the speakerphone charger as shown below.

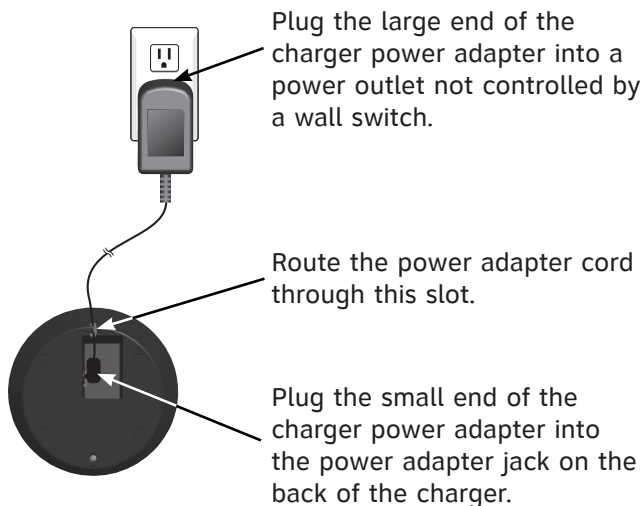

IMPORTANT INFORMATION

- Use only the power adapter provided with this product. To obtain a replacement, visit our website at www.telephones.att.com or call **1 (800) 222-3111**. In Canada, dial **1 (866) 288-4268**.
- The power adapter is intended to be correctly oriented in a vertical or floor mount position. The prongs are not designed to hold the plug in place if it is plugged into a ceiling, under-the-table or cabinet outlet.

Battery installation and charging

Install the battery as shown below.



1. Plug the battery connector securely into the socket inside the speakerphone battery compartment, matching the color-coded label.
2. Insert the supplied battery with the label **THIS SIDE UP** facing up as indicated.



3. Insert the tab on the bottom of the battery compartment cover into the battery compartment, then press down gently on the cover until it snaps into place.

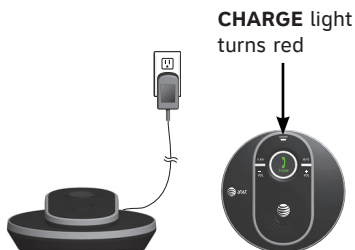

4. Charge the speakerphone by placing it face upward in the charger. The **CHARGE** light on the speakerphone turns red during charging.

To replace the battery, push the tab and lift the battery compartment cover up and off. Lift out the old battery and disconnect it from the speakerphone. Follow the instructions above to install and charge the new battery.



Battery installation and charging

IMPORTANT INFORMATION

- Use only the supplied rechargeable battery or replacement battery (model BT185742/BT285742). To order, visit our website at **www.telephones.att.com** or call **1 (800) 222-3111**. In Canada, dial **1 (866) 288-4268**.
- If you do not use the speakerphone for a long time, disconnect and remove the battery to prevent possible leakage.

Once you have installed the battery, the **CHARGE** light on the speakerphone indicates the battery status (see the table below). If necessary, place the speakerphone in the charger to charge the battery. For optimal performance, keep the speakerphone in the charger when not in use. The battery is fully charged after 11 hours of continuous charging. See Technical specifications on page 45 for battery operating times.

CHARGE light	Battery status
Red: Flashes every 10 seconds.	Battery has very little charge and needs charging when the speakerphone is out of the charger.
Red: Steadily on.	Battery is charging.
Green: Steadily on.	Battery is fully charged when the speakerphone is in the charger.



NOTES:

- If you are on a call in low battery mode, you hear a low battery alert tone every 60 seconds.
- If the battery is not properly installed or no battery is installed in the speakerphone, when you place it in the charger, the **CHARGE** light is off. Follow the instructions on page 3 to install the battery.

Adding and registering a speakerphone

Before using a new TL80133 speakerphone, you must register it with an AT&T business phone, an AT&T CL, CRL, CLP, or TL series home cordless phone, or a VTech DS, SN, or IS series home cordless phone. All these compatible telephone systems are purchased separately. Visit **www.telephones.att.com** for a complete list of compatible phones.

When first purchased or when the speakerphone is not registered, the voice prompt "Not registered" plays once upon every key press.

Register a speakerphone to a telephone base



NOTES:

- Make sure the speakerphone battery is properly installed (see page 3).
- Make sure your telephone system is not in use.
- Keep the speakerphone out of the charger.

For AT&T models with /HANDSET LOCATOR button on the telephone base:

1. Press and hold the  /HANDSET LOCATOR button for about four seconds.
 - The **IN USE** light turns on, or
 - The base displays **Registering... Please wait.**
2. Release the button.
3. Place the speakerphone in the charger.
 - The **CHARGE** light flashes red and green alternately to indicate the registration is in progress. This may take up to five minutes to complete.
4. Once registered, you hear a confirmation tone.
 - To verify the registration is successful, press the **PHONE** button, and check for a dial tone.

CHARGE light flashes red and green



Adding and registering a speakerphone

For AT&T models without /HANDSET LOCATOR button on the telephone base:

1. Press **MENU** on the telephone base in idle mode.
2. Scroll to **Settings**, and then press **SELECT**.
3. Scroll to **Registration**, and then press **SELECT**.
 - The base displays **Registering... Please wait**.
4. Follow Steps 3 and 4 under **For AT&T models with /HANDSET LOCATOR button on the telephone base** section.

For AT&T Synapse® business phone system:



1. Press **MENU**, **2**, and then **6** on the telephone base in idle mode. The **Cordless Headset** menu appears.
2. Press **Register**.
 - The base displays **Registering in Progress...**
3. Follow Steps 3 and 4 under **For AT&T models with /HANDSET LOCATOR button on the telephone base** section.

For AT&T Syn248® business phone system:

1. Press **☰ (MENU)**, **2**, and then **5** on the telephone base in idle mode. The **Cordless Headset Registration** menu appears.
2. Press **Register**.
 - The base displays **Registering in Progress...**
3. Follow Steps 3 and 4 under **For AT&T models with /HANDSET LOCATOR button on the telephone base** section.

Adding and registering a speakerphone

For VTech models:

1. Press and hold the /**FIND HANDSET** button on the telephone base for about four seconds.
 - The **IN USE** light turns on.
2. Release the button.
3. Follow Steps 3 and 4 under **For AT&T models with /HANDSET LOCATOR button on the telephone base** section.



NOTES:

- You can register a maximum of two TL80133 speakerphones to a cordless telephone. The telephone base recognizes and counts a speakerphone the same as a headset.
- If the base has no prior registered speakerphone or headset, the newly-registered speakerphone is listed as **HDST/SPK** or **HEADSET** in the intercom menu. Otherwise, the prior registered speakerphone or headset is listed as **HDST/SPK1** or **HEADSET 1**, and the newly registered speakerphone or headset is listed as **HDST/SPK2** or **HEADSET 2**.
- If the registration fails, you will hear three beeps and the voice prompt "Not registered" plays once upon every key press. As such, reset the speakerphone. Remove the battery from the speakerphone, and insert it back into the speakerphone. Repeat the registration steps.

Replacing a speakerphone

You may need to deregister your speakerphones if:

You want to register your speakerphone to a different telephone base.

-OR-

You already have two registered speakerphones on the telephone base and need to replace one of them.

-OR-

You wish to reassign the designated speakerphone number. To do so, you must deregister all the speakerphones and then individually register each speakerphone again.

Please read carefully through all the instructions on this page before beginning the deregistration process.

Deregister all speakerphones

To deregister all speakerphones from the telephone base, follow the instructions in the user's manual of your telephone system, or visit our website at **www.telephones.att.com**.

This operation will deregister all the DECT handsets, headsets, and cordless speakerphones, regardless of their battery status and whether they are within range or out-of-range.



NOTE: You cannot deregister the speakerphone(s) if any system device is in use.

Quick reference guide - speakerphone

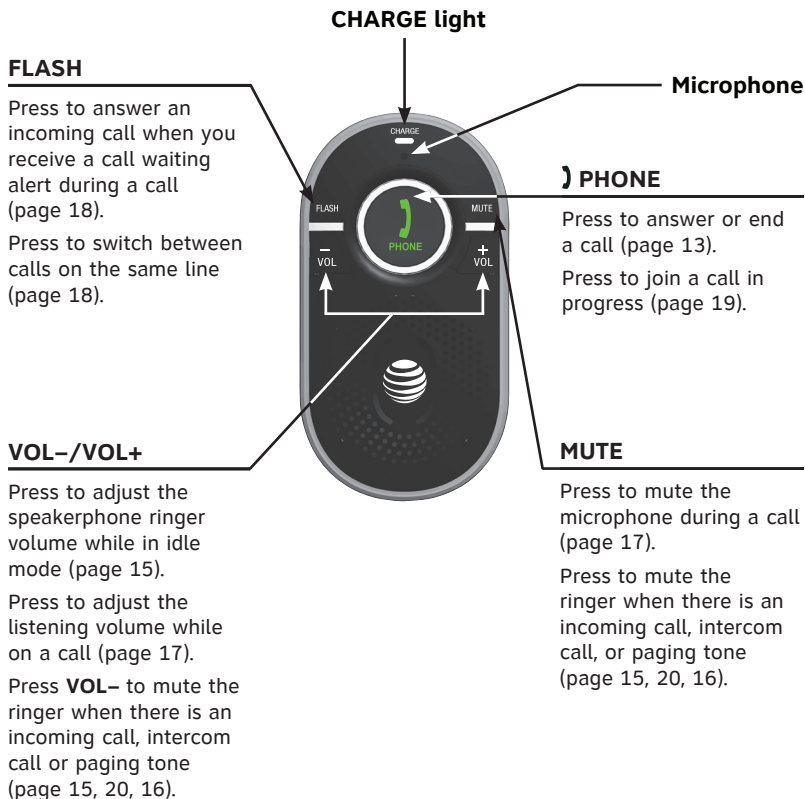

Quick reference guide - speakerphone

Speakerphone lights

CHARGE light	
Red	<ul style="list-style-type: none"> • On when the speakerphone is charging. • Flashes once every 10 seconds to indicate the battery is low when the speakerphone is out of the charger.
Green	<ul style="list-style-type: none"> • On when the speakerphone is in the charger and the battery is full.
Red and green	<ul style="list-style-type: none"> • Flashes quickly when the speakerphone is in registration mode. • Flashes during paging from the telephone base. • Flashes twice when there is an error.
Off	<ul style="list-style-type: none"> • The speakerphone is out of the charger. • No battery is installed.

Key backlights	
MUTE (Red)	<ul style="list-style-type: none"> • On when the speakerphone microphone is turned off during a call.
) PHONE (Green)	<ul style="list-style-type: none"> • On when the speakerphone is in use. • Flashes three times when there is an incoming call or intercom. • Flashes twice every three seconds when any line is in use or on hold by other system devices. • Flashes once when the speakerphone is successfully reset.

Quick reference guide - speakerphone

Speakerphone alert tones

One short beep every 30 seconds	<ul style="list-style-type: none">• The microphone is muted.
Two beeps	<ul style="list-style-type: none">• Error alert tone.• The volume has reached its highest or lowest setting.
Two low beeps	<ul style="list-style-type: none">• Call waiting alert tone.
Two rapid beeps every 60 seconds	<ul style="list-style-type: none">• The battery is low and the speakerphone is in use.
Three rapid beeps	<ul style="list-style-type: none">• The speakerphone is successfully reset.• The speakerphone is deregistered.
Three rapid beeps every 10 seconds	<ul style="list-style-type: none">• The speakerphone is out of range while on a call.
Confirmation tone	<ul style="list-style-type: none">• The speakerphone is successfully registered to a telephone base.

Quick reference guide - speakerphone

Speakerphone voice prompts

<i>"Not registered"</i>	<ul style="list-style-type: none">• Plays upon every key press when the speakerphone is not registered.
<i>"Out of range"</i>	<ul style="list-style-type: none">• Plays upon every key press when the speakerphone is out of range.
<i>"Low battery"</i>	<ul style="list-style-type: none">• Plays every five minutes when the battery is low.
<i>"Mute on"</i>	<ul style="list-style-type: none">• Plays when you press MUTE while on a call.
<i>"Mute off"</i>	<ul style="list-style-type: none">• Plays when you press MUTE again while on a call after the microphone is off.

Speakerphone operation

Make a call

The speakerphone is not designed to make outgoing calls. Calling has to be done via a telephone base or a handset, and then joined by the speakerphone.



1. Use the dialing keys of your phone for making calls.
2. Press **PHONE** on the speakerphone at any time to join the call.
3. After you join the call on the speakerphone, you can hang up the phone and continue the call on the speakerphone.

Answer a call

Press **PHONE** on the speakerphone.



NOTES:

- When there is more than one simultaneous incoming call from different lines (landline, cell line or PC line), pressing **PHONE** will answer the first ringing line.
- You can answer a call regardless of whether the speakerphone is in the charger.
- If the auto-off feature is disabled (see page 14), the call continues even if you place the speakerphone in the charger during the call.

End a call

Press **PHONE** on the speakerphone.

-OR-

Place the speakerphone in the charger if the auto-off feature is enabled (see page 14).

Speakerphone operation

Auto-off

The auto-off feature enables you to end a call by placing the speakerphone in the charger. By default this feature is disabled.

To enable auto-off:

- When the speakerphone is not in use, enter the following code on the speakerphone by pressing the keys in this order:
) PHONE, VOL-, VOL-,) PHONE, VOL+, VOL-, VOL+,) PHONE.

To disable auto-off:

- When the speakerphone is not in use, enter the following code on the speakerphone by pressing the keys in this order:
) PHONE, VOL+, VOL+,) PHONE, VOL-, VOL+, VOL-,) PHONE.

You hear three beeps once the feature is enabled or disabled.

Speakerphone operation

Speakerphone ringer

To change the speakerphone ringer volume:

- Press **VOL+** or **VOL-** when the speakerphone is not in use to sample each volume level.



To turn off the speakerphone ringer volume:

- Press **VOL-** until you hear two beeps when the speakerphone is not in use.



NOTES:

- If the ringer volume is turned off, the speakerphone is silenced for all calls.
- If the ringer volume of the telephone base/handset(s) is set to off, the speakerphone is silenced for all calls regardless of its own ringer volume setting.
- The ringer volume level also determines the ringer levels of intercom calls (see page 20).
- The speakerphone can play cell ringer for cell calls if the telephone system the speakerphone is registered to supports the cell ringer feature.

Temporary ringer silencing



When there is an incoming call, you can press **VOL-** or **MUTE** to temporarily silence the ring tone on the speakerphone. This silences the ring tone without disconnecting the call. The next incoming call rings at the preset volume.



NOTE: If you have more than one speakerphone registered to the telephone base, all speakerphones receive the ring tone when there is an incoming call. Pressing **MUTE** on one speakerphone only silences the ring tone of that particular speakerphone.

Speakerphone operation

Speakerphone paging

On the telephone base the speakerphone is registered to, press /**HANDSET LOCATOR** or /**FIND HANDSET** to page the speakerphone and all system devices. The speakerphone plays the paging tone regardless of its ringer volume setting and the **CHARGE** light flashes red and green.

To mute the paging tone:

- Press **MUTE** or **VOL-** on the speakerphone.

To end paging:

- Press /**HANDSET LOCATOR** or /**FIND HANDSET** on the telephone base.

-OR-

- Press **) PHONE** on the speakerphone.



NOTE: If there is no response after 60 seconds, the paging ends.

Options while on calls

Volume control

To adjust the listening volume:

- While on a call, press **VOL+** or **VOL-** on the speakerphone to adjust the listening volume.



NOTES:

- Listening volume settings are independent for each speakerphone.
- When the listening volume reaches the minimum or maximum setting, you hear two beeps.

Mute

The mute function turns off the speakerphone microphone. You can hear the caller, but the caller cannot hear you.

To mute a call:

- Press **MUTE** on the speakerphone to turn off the speakerphone microphone. The voice prompt "*Mute on*" plays. The **MUTE** light on the speakerphone turns on and a short beep plays every 30 seconds.



To take a call off mute:

- Press **MUTE** on the speakerphone to resume the two-way conversation. You hear the voice prompt "*Mute off*".

Options while on calls

Flash/call waiting

If you subscribe to call waiting service offered by your telephone service provider, you will hear a call waiting alert tone if someone calls you while you are in the middle of a call.

If the incoming call is from the same line of the current call:

- Press **FLASH** on the speakerphone to put your current call on hold and answer the new call.
- Press **FLASH** again at any time to switch back and forth between calls.



For the multi-line telephone system, if the incoming call is from a different line of the current call:

- Press **FLASH** on the speakerphone to put your current call on hold. This does not pick up the new call from another line.
- Press **) PHONE** on the speakerphone to end the current call, then press **) PHONE** again when the speakerphone rings to answer the incoming call from another line.

Options while on calls

Join a call in progress

The speakerphone can join an external call in progress with telephone base, handsets and headsets on the same telephone line, creating a conference call. The number of devices that can join may be limited by your telephone system. See your telephone user's manual for more information.



To join a call:

- Press **PHONE** on the speakerphone. The conference begins.

To end a call on the speakerphone:

- Press **PHONE** on the speakerphone.

-OR-

- Place the speakerphone in the charger if the auto-off feature is enabled (see page 13).

The call continues until all devices hang up.



NOTE: If the speakerphone is registered to a multi-line telephone system and more than one line is in use or on hold, pressing **PHONE** on the speakerphone will join the line in the following order:

1. Landline 1
2. Landline 2
3. Cell line A
4. Cell line B

Intercom

Intercom calls and transfers

Use the intercom feature for conversations between a system handset and a speakerphone, or a telephone base and a speakerphone. Only one intercom call can be established at a time. Follow the instructions in your telephone user's manual for intercom calls and call transfers using intercom.

The speakerphone is listed as **HDST/SPK** or **HEADSET** in the intercom menu. You can use the dialing keys on your phone for entering the speakerphone device number in the intercom menu:

- If the base has one registered speakerphone and has no registered headset, press **#** (pound key) to select the registered speakerphone.
- If the base has two registered speakerphones, press **#1** for speakerphone 1 and **#2** for speakerphone 2.

To answer an intercom call:

- Press **) PHONE** on the speakerphone.

To end an intercom call:

- Press **) PHONE** on the speakerphone.

-OR-

- Place the speakerphone in the charger if the auto-off feature is enabled (see page 13).



NOTES:

- You can only make intercom calls or transfers from a telephone base/cordless handset to the speakerphone.
- If you select the **All** option in the intercom menu, the speakerphone will not ring.
- You can press **MUTE** or **VOL-** to temporarily silence the intercom ringer on the speakerphone.
- The intercom request times out in 100 seconds.

Answer an incoming call during an intercom call

1. During an intercom call, press **PHONE** on the speakerphone to end the intercom session.
2. The ringer of the incoming call rings. Press **PHONE** again to answer the incoming call.



NOTES:

- When there is more than one simultaneous incoming call from different lines (landline, cell line or PC line), pressing **PHONE** will answer the first ringing line.
- You can answer a call regardless of whether the speakerphone is in the charger.

Troubleshooting

If you have difficulty with your speakerphone, please try the suggestions below. For customer service, visit our website at **www.telephones.att.com** or call **1 (800) 222-3111**. In Canada, dial **1 (866) 288-4268**.

My speakerphone doesn't work at all.

- Make sure the battery connector is securely plugged into the cordless speakerphone.
- Charge the battery in the cordless speakerphone for at least 11 hours. For optimum daily performance, return the cordless speakerphone to the charger when not in use.
- Reset the speakerphone. Remove the battery from the speakerphone, then insert the battery back into the speakerphone.
- Other electronic products such as HAM radios and other DECT phones can cause interference with your cordless speakerphone. Try installing the telephone base your speakerphone is registered to as far away as possible from these types of electronic devices.
- You may need a new battery. Refer to pages 3-4 of this user's manual.

Troubleshooting

I cannot get a dial tone.

- Try all the suggestions above.
- Make sure you have registered the speakerphone to your telephone base.
- Move the cordless speakerphone closer to the telephone base. You might have moved out of range.
- The telephone line cord of the telephone base might be defective. Try installing a new telephone line cord.
- If the previous suggestions do not work, you may test the telephone line by plugging a different telephone into the telephone jack that you are using. If there is no dial tone on that phone either, the problem is in your wiring or telephone service. Contact your telephone service provider (charges may apply).

I am getting a buzzing sound on my speakerphone or handset/telephone base speakerphone.

- Your telephone may experience interference from the speakerphone. To overcome this problem, move the speakerphone at least 12 inches away from the telephone base.
- Other electronic products such as HAM radios and other DECT phones can cause interference with your cordless speakerphone. Try installing the telephone base your speakerphone is registered to as far away as possible from these types of electronic devices.

Troubleshooting

I cannot dial out.

- The speakerphone is not designed to make outgoing calls. Calling has to be done via a telephone base or a handset, and then joined by the speakerphone (page 13).

The other party cannot hear my voice during a call.

- Make sure the call is not muted (page 17).

My cordless speakerphone isn't performing normally.

- Make sure you have registered the speakerphone to your telephone base.
- Move the cordless speakerphone closer to the telephone base. You might have moved out of range.
- Reset the speakerphone. Remove the battery from the speakerphone, then insert the battery back into the speakerphone.
- Other electronic products such as HAM radios and other DECT phones can cause interference with your cordless speakerphone. Try installing the telephone base your speakerphone is registered to as far away as possible from these types of electronic devices.

Troubleshooting

I want to use my speakerphone with a different telephone base.

- You need to deregister the speakerphone from the current telephone base (page 8) and then register it to the new telephone base (pages 5-7).

The batteries do not hold a charge.

- Make sure that the speakerphone battery is installed and securely plugged into the connector.
- If the cordless speakerphone is in the charger and the **CHARGE** light on the speakerphone does not turn on, refer to **The CHARGE light on the speakerphone is off while charging** in this **Troubleshooting** guide.
- Charge the battery in the cordless speakerphone for at least 11 hours. For optimum daily performance, return the cordless speakerphone to the charger when not in use.
- You may need a new battery. Refer to **Battery installation and charging** on pages 3-4.
- Your speakerphone might be defective. Refer to **Limited warranty** on pages 41-44 for further instructions.

Troubleshooting

I get noise, static, or weak signal even when I'm near the telephone base.

- If you subscribe to high-speed Internet service (DSL - digital subscriber line) through your telephone line, you must install a DSL filter between the telephone line cord and the telephone wall jack. The filter prevents noise and caller ID problems caused by DSL interference. Contact your DSL service provider for more information about DSL filters.
- You may be able to improve the performance of your cordless speakerphone by installing the telephone base your speakerphone is registered to as far as possible from any existing corded/cordless telephone system.
- Other electronic products such as HAM radios and other DECT phones can cause interference with your cordless speakerphone. Try installing the telephone base your speakerphone is registered to as far away as possible from these types of electronic devices.
- Do not install this speakerphone near a microwave oven or on the same electrical outlet. You may experience decreased performance while the microwave oven is operating.
- Relocate the telephone base your speakerphone is registered to to a higher location. You may experience better reception by elevating the telephone base.
- If the other phones in your home are having the same problem, the problem is in your wiring or telephone service. Contact your telephone service provider (charges may apply).

Troubleshooting

I hear other calls while using my speakerphone.

- Test the telephone line by plugging a different telephone into the telephone jack that you are using. If you still hear other calls, the problem is probably in your building's wiring or telephone service. Contact your telephone service provider (charges may apply).

My calls cut in and out while I'm using my cordless speakerphone.

- Other electronic products such as HAM radios and other DECT phones can cause interference with your cordless speakerphone. Try installing the telephone base your speakerphone is registered to as far away as possible from these types of electronic devices.
- Do not install the speakerphone near a microwave oven or on the same electrical outlet. You may experience decreased performance while the microwave oven is operating.
- Relocate the telephone base your speakerphone is registered to to a higher location. You may experience better reception by elevating the base.
- If the other phones in your home are having the same problem, the problem is in your wiring or telephone service. Contact your telephone service provider (charges may apply).

Troubleshooting

I cannot hear a ring tone from the speakerphone when there is an incoming call.

- Make sure you have registered the speakerphone to your telephone base.
- If you have pressed **MUTE** or **VOL-** on the speakerphone when it is ringing, it mutes the ring tone of the speakerphone. The ring tone resumes on the next call.
- You may have too many extension phones on your telephone line to allow all of them to ring simultaneously. Try unplugging some of the other phones.
- The layout of your home or office might be limiting the operating range. Try moving the telephone base your speakerphone is registered to to another location, preferably on an upper floor.
- Test a working phone at the phone jack. If another phone has the same problem, the problem is the phone jack, wiring or telephone service. Contact your telephone service provider (charges may apply).
- Other electronic products such as HAM radios and other DECT phones can cause interference with your cordless speakerphone. Try installing the telephone base your speakerphone is registered to as far away as possible from these types of electronic devices.
- Reset the speakerphone. Remove the battery from the speakerphone, then insert the battery back into the speakerphone.
- Your telephone line cord might be defective. Try installing a new telephone line cord.

Troubleshooting

The CHARGE light on the speakerphone is off while charging.

- Make sure the power cord of the charger is plugged in correctly and securely.
- Make sure that the battery connector is securely plugged into the cordless speakerphone.
- Place the speakerphone face upward in the charging cradle until the **CHARGE** light on the speakerphone turns on.
- Remove the battery from the speakerphone, then insert the battery back into the speakerphone.
- Clean the cordless speakerphone and charger charging contacts each month using a pencil eraser or cloth.
- Your speakerphone or charger might be defective. Refer to **Limited warranty** on pages 41-44 for further instructions.

Common cure for electronic equipment.

If the unit does not seem to respond normally, do the following (in the order listed):

- Remove the battery from the speakerphone.
- Wait for a few minutes.
- Install the battery again into the speakerphone.

Important safety information



This symbol is to alert you to important operating or servicing instructions that may appear in this user's manual. Always follow basic safety precautions when using this product to reduce the risk of injury, fire or electric shock.

Safety information

- **Read and understand all instructions in the user's manual. Observe all markings on the product.**
- **Avoid using a telephone during a thunderstorm.** There may be a slight chance of electric shock from lightning.
- **Do not use a telephone to report a gas leak in the vicinity of the leak.** Under certain circumstances, a spark may be created when the adapter is plugged into the power outlet or when the speakerphone is replaced on its cradle. This is a common event associated with the closing of any electrical circuit. The user should not plug the phone into a power outlet, and should not put a charged speakerphone on the cradle, if the phone is located in an environment containing concentrations of flammable or flame-supporting gases, unless there is adequate ventilation. A spark in such an environment could create a fire or explosion. Such environments might include: medical use of oxygen without adequate ventilation; industrial gases (cleaning solvents; gasoline vapors; etc.); a leak of natural gas; etc.
- **Do not use this product near water, or when you are wet.** For example, do not use it in a wet basement or shower, or next to a swimming pool, bathtub, kitchen sink, or laundry tub. Do not use liquids or aerosol sprays for cleaning. If the product comes in contact with any liquids, unplug any line or power cord immediately. Do not plug the product back in until it has dried thoroughly.
- **Install this product in a protected location** where no one can trip over any line or power cords. Protect cords from damage or abrasion.

Important safety information

- **If this product does not operate normally, see the Troubleshooting section on pages 22-29 in this user's manual.** If you cannot solve the problem, or if the product is damaged, refer to **Limited warranty** on pages 41-44. Do not open this product except as may be directed in your user's manual. Opening the product or reassembling it incorrectly may expose you to hazardous voltages or other risks.
- **Replace batteries only as described in Battery installation and charging on pages 3-4 in your user's manual.** Do not burn or puncture batteries — they contain caustic chemicals.
- **This power adapter is intended to be correctly oriented in a vertical or floor mount position.** The prongs are not designed to hold the plug in place if it is plugged into a ceiling, an under-the-table or cabinet outlet.



CAUTION: Use only the power adapter provided with this product. To obtain a replacement, visit our website at **www.telephones.att.com** or call **1 (800) 222-3111**. In Canada, dial **1 (866) 288-4268**.

Especially about cordless speakerphones

- **Privacy:** The same features that make a cordless speakerphone convenient create some limitations. Telephone calls are transmitted between the telephone base and the speakerphone by radio waves, so there is a possibility that your cordless speakerphone conversations could be intercepted by radio receiving equipment within range of the cordless speakerphone. **For this reason, you should not think of cordless speakerphone conversations as being as private as those on corded telephones.**
- **Electrical power:** The telephone base this cordless speakerphone is registered to must be connected to a working electrical outlet which is not controlled by a wall switch. **Calls cannot be answered by the speakerphone if the telephone base is unplugged or switched off, or if the electrical power is interrupted.**

Important safety information

- **Potential TV interference:** Some cordless speakerphones operate at frequencies that may cause interference to TVs and VCRs. To minimize or prevent such interference, do not place the cordless speakerphone near or on top of a TV or VCR. If interference is experienced, moving the cordless speakerphone farther away from the TV or VCR will often reduce or eliminate the interference.
- **Rechargeable batteries:** This product contains nickel-metal hydride rechargeable batteries. Exercise care in handling batteries in order not to create a short circuit with conductive material such as rings, bracelets and keys. The battery or conductor may overheat and cause harm. Observe proper polarity between the battery and the battery charger.
- **Nickel-metal hydride rechargeable batteries:** Dispose of these batteries in a safe manner. Do not burn or puncture. Like other batteries of this type, if burned or punctured, they could release caustic material which could cause injury.



The RBRC™ Seal means that the manufacturer is voluntarily participating in an industry program to collect and recycle nickel-metal hydride rechargeable batteries when taken out of service within the United States. These batteries may be taken to a participating local retailer of replacement batteries or recycling center. Or you may call 1-800-8-BATTERY for locations accepting spent Ni-MH batteries.

Important safety information

Precautions for users of implanted cardiac pacemakers

Cardiac pacemakers (applies only to digital cordless telephones):

Wireless Technology Research, LLC (WTR), an independent research entity, led a multidisciplinary evaluation of the interference between portable cordless telephones and implanted cardiac pacemakers. Supported by the U.S. Food and Drug Administration, WTR recommends to physicians that:

Pacemaker patients

- Should keep cordless telephones at least six inches from the pacemaker.
- Should NOT place cordless telephones directly over the pacemaker, such as in a breast pocket, when it is turned ON.
- Should use the cordless telephone at the ear opposite the pacemaker.

WTR's evaluation did not identify any risk to bystanders with pacemakers from other persons using cordless telephones.

SAVE THESE INSTRUCTIONS

Maintenance

Taking care of your speakerphone

- Your cordless speakerphone contains sophisticated electronic parts, so it must be treated with care.
- Avoid rough treatment.
- Place the speakerphone down gently. Save the original packing materials to protect your speakerphone if you ever need to ship it.

Avoid water

- Your speakerphone can be damaged if it gets wet. Do not use the speakerphone outdoors in the rain, or handle it with wet hands. Do not install the speakerphone charger near a sink, bathtub or shower.

Electrical storms

- Electrical storms can sometimes cause power surges harmful to electronic equipment. For your own safety, take caution when using electrical appliances during storms.

Cleaning your speakerphone

- Your speakerphone has a durable plastic casing that should retain its luster for many years. Clean it only with a soft cloth slightly dampened with water or a mild soap.
- Do not use excess water or cleaning solvents of any kind.

Remember that electrical appliances can cause serious injury if used when you are wet or standing in water. If the telephone base should fall into water, DO NOT RETRIEVE IT UNTIL YOU UNPLUG THE POWER CORD AND TELEPHONE LINE CORDS FROM THE WALL. Pull the telephone out by the unplugged cords.

FCC, ACTA and IC regulations

FCC Part 68 and ACTA

This equipment complies with Part 68 of the FCC rules and with technical requirements adopted by the Administrative Council for Terminal Attachments (ACTA). The label on the back or bottom of this equipment contains, among other things, a product identifier in the format US:AAAEQ##TXXXX. This identifier must be provided to your telephone service provider upon request.

The plug and jack used to connect this equipment to premises wiring and the telephone network must comply with applicable Part 68 rules and technical requirements adopted by ACTA. A compliant telephone cord and modular plug is provided with this product. It is designed to be connected to a compatible modular jack that is also compliant. An RJ11 jack should normally be used for connecting to a single line and an RJ14 jack for two lines. See Installation Instructions in the user's manual.

The Ringer Equivalence Number (REN) is used to determine how many devices you may connect to your telephone line and still have them ring when you are called. The REN for this product is encoded as the 6th and 7th characters following the US: in the product identifier (e.g., if ## is 03, the REN is 0.3). In most, but not all areas, the sum of all RENs should be five (5.0) or less. For more information, please contact your telephone service provider.

This equipment may not be used with Party Lines. If you have specially wired alarm dialing equipment connected to your telephone line, ensure the connection of this equipment does not disable your alarm equipment. If you have questions about what will disable alarm equipment, consult your telephone service provider or a qualified installer.

If this equipment is malfunctioning, it must be unplugged from the modular jack until the problem has been corrected. Repairs to this telephone equipment can only be made by the manufacturer or its authorized agents. For repair procedures, follow the instructions outlined under the Limited Warranty.

FCC, ACTA and IC regulations

If this equipment is causing harm to the telephone network, the telephone service provider may temporarily discontinue your telephone service. The telephone service provider is required to notify you before interrupting service. If advance notice is not practical, you will be notified as soon as possible. You will be given the opportunity to correct the problem and the telephone service provider is required to inform you of your right to file a complaint with the FCC. Your telephone service provider may make changes in its facilities, equipment, operation, or procedures that could affect the proper functioning of this product. The telephone service provider is required to notify you if such changes are planned.

If this product is equipped with a corded or cordless handset, it is hearing aid compatible.

If this product has memory dialing locations, you may choose to store emergency telephone numbers (e.g., police, fire, medical) in these locations. If you do store or test emergency numbers, please:

- Remain on the line and briefly explain the reason for the call before hanging up.
- Perform such activities in off-peak hours, such as early morning or late evening.

FCC, ACTA and IC regulations

Industry Canada

This device complies with Industry Canada licence-exempt RSS standard(s).

Operation is subject to the following two conditions: (1) this device may not cause harmful interference, and (2) this device must accept any interference received, including interference that may cause undesired operation.

Privacy of communications may not be ensured when using this device.

The term "IC:" before the certification/registration number only signifies that the Industry Canada technical specifications were met.

The Ringer Equivalence Number (REN) for this terminal equipment is 0.1. The REN is an indication of the maximum number of devices allowed to be connected to a telephone interface. The termination on an interface may consist of any combination of devices subject only to the requirement that the sum of the RENs of all the devices does not exceed five.

This product meets the applicable Industry Canada technical specifications.

FCC, ACTA and IC regulations

FCC Part 15

This equipment has been tested and found to comply with the requirements for a Class B digital device under Part 15 of the Federal Communications Commission (FCC) rules.

These requirements are intended to provide reasonable protection against harmful interference in a residential installation. This equipment generates, uses and can radiate radio frequency energy and, if not installed and used in accordance with the instructions, may cause harmful interference to radio communications. However, there is no guarantee that interference will not occur in a particular installation.

If this equipment does cause harmful interference to radio or television reception, which can be determined by turning the equipment off and on, the user is encouraged to try to correct the interference by one or more of the following measures:

- Reorient or relocate the receiving antenna.
- Increase the separation between the equipment and receiver.
- Connect the equipment into an outlet on a circuit different from that to which the receiver is connected.
- Consult the dealer or an experienced radio/TV technician for help.

Changes or modifications to this equipment not expressly approved by the party responsible for compliance could void the user's authority to operate the equipment.

This device complies with Part 15 of the FCC Rules. Operation is subject to the following two conditions: (1) this device may not cause harmful interference, and (2) this device must accept any interference received, including interference that may cause undesired operation. Privacy of communications may not be ensured when using this device.

FCC, ACTA and IC regulations





To ensure safety of users, the FCC has established criteria for the amount of radio frequency energy that can be safely absorbed by a user or bystander according to the intended usage of the product. This product has been tested and found to comply with the FCC criteria. The telephone base shall be installed and used such that parts of the user's body other than the hands are maintained at a distance of approximately 20 cm (8 inches) or more.

This Class B digital apparatus complies with Canadian requirement: CAN ICES-3 (B)/NMB-3(B)

California Energy Commission battery charging testing instructions

This telephone is set up to comply with the energy-conserving standards right out of the box. These instructions are intended for California Energy Commission (CEC) compliance testing only. When the CEC battery charging testing mode is activated, all telephone functions, except battery charging, will be disabled.

To activate the CEC battery charging testing mode:

1. Unplug the telephone base power adapter from the power outlet. Make sure all speakerphones are plugged with charged batteries before proceeding.
2. While you press and hold /HANDSET LOCATOR, HOLD, or /FIND HANDSET, plug the telephone base power adapter back to the power outlet.
3. After about 20 seconds, when the **IN USE** light starts flashing or the telephone base shows **Deregister all devices?**, release /HANDSET LOCATOR, HOLD, or /FIND HANDSET, and then immediately press the button again.



When the speakerphone successfully enters the CEC battery charging testing mode, the voice prompt "*Not registered*" plays once upon every key press.

When the speakerphone fails to enter this mode, repeat Step 1 through Step 3 above.

To deactivate the CEC battery charging testing mode:

1. Unplug the telephone base power adapter from the power outlet, then plug it back in. The telephone base is powered up as normal.
2. Register your speakerphone(s) back to the telephone base. See pages 5-7 for speakerphone registration instructions.



NOTE: For users of AT&T business phones, refer to the user's manual of your respective model for deregistration instructions for activating the CEC battery charging testing mode.

Limited warranty

The AT&T brand is used under license - any repair, replacement or warranty service, and all questions about this product should be directed to: In the United States of America, visit

www.telephones.att.com or call **1 (800) 222-3111**.

In Canada, dial **1 (866) 288-4268**.

1. What does this limited warranty cover?

The manufacturer of this AT&T branded product warrants to the holder of a valid proof of purchase (“CONSUMER” or “you”) that the product and all accessories provided in the sales package (“PRODUCT”) are free from defects in material and workmanship, pursuant to the following terms and conditions, when installed and used normally and in accordance with the PRODUCT operating instructions. This limited warranty extends only to the CONSUMER for products purchased and used in the United States of America and Canada.

2. What will be done if the PRODUCT is not free from defects in materials and workmanship during the limited warranty period (“materially defective PRODUCT”)?

During the limited warranty period, the manufacturer’s authorized service representative will repair or replace at the manufacturer’s option, without charge, a materially defective PRODUCT. If the manufacturer repairs the PRODUCT, they may use new or refurbished replacement parts. If the manufacturer chooses to replace the PRODUCT, they may replace it with a new or refurbished PRODUCT of the same or similar design. The manufacturer will retain defective parts, modules, or equipment. Repair or replacement of the PRODUCT, at the manufacturer’s option, is your exclusive remedy. The manufacturer will return repaired or replacement products to you in working condition.

You should expect the repair or replacement to take approximately 30 days.

Limited warranty

3. How long is the limited warranty period?

The limited warranty period for the PRODUCT extends for ONE (1) YEAR from the date of purchase. If the manufacturer repairs or replaces a materially defective PRODUCT under the terms of this limited warranty, this limited warranty also applies to repaired or replacement PRODUCT for a period of either (a) 90 days from the date the repaired or replacement PRODUCT is shipped to you or (b) the time remaining on the original one-year limited warranty; whichever is longer.

4. What is not covered by this limited warranty?

This limited warranty does not cover:

- PRODUCT that has been subjected to misuse, accident, shipping or other physical damage, improper installation, abnormal operation or handling, neglect, inundation, fire, water, or other liquid intrusion; or
- PRODUCT that has been damaged due to repair, alteration, or modification by anyone other than an authorized service representative of the manufacturer; or
- PRODUCT to the extent that the problem experienced is caused by signal conditions, network reliability or cable or antenna systems; or
- PRODUCT to the extent that the problem is caused by use with non-AT&T accessories; or
- PRODUCT whose warranty/quality stickers, PRODUCT serial number plates or electronic serial numbers have been removed, altered or rendered illegible; or
- PRODUCT purchased, used, serviced, or shipped for repair from outside the United States of America or Canada, or used for commercial or institutional purposes (including but not limited to products used for rental purposes); or

Limited warranty

- PRODUCT returned without a valid proof of purchase (see item 6 below); or
- Charges for installation or setup, adjustment of customer controls, and installation or repair of systems outside the unit.

5. How do you get warranty service?

To obtain warranty service in the United States of America, visit **www.telephones.att.com** or call **1 (800) 222-3111**. In Canada, call **1 (866) 288-4268**.

NOTE: Before calling for service, please review the user's manual; a check of the PRODUCT's controls and features may save you a service call.

Except as provided by applicable law, you assume the risk of loss or damage during transit and transportation and are responsible for delivery or handling charges incurred in the transport of the PRODUCT(s) to the service location. The manufacturer will return repaired or replaced PRODUCT under this limited warranty to you. Transportation, delivery or handling charges are prepaid. The manufacturer assumes no risk for damage or loss of the PRODUCT in transit. If the PRODUCT failure is not covered by this limited warranty, or proof of purchase does not meet the terms of this limited warranty, the manufacturer will notify you and will request that you authorize the cost of repair prior to any further repair activity. You must pay for the cost of repair and return shipping costs for the repair of products that are not covered by this limited warranty.

6. What must you return with the PRODUCT to get warranty service?

You must:

- a. Return the entire original package and contents including the PRODUCT to the service location along with a description of the malfunction or difficulty; and

Limited warranty

- b. Include a “valid proof of purchase” (sales receipt) identifying the PRODUCT purchased (PRODUCT model) and the date of purchase or receipt; and
- c. Provide your name, complete and correct mailing address, and telephone number.

7. Other limitations

This warranty is the complete and exclusive agreement between you and the manufacturer of this AT&T branded PRODUCT. It supersedes all other written or oral communications related to this PRODUCT. The manufacturer provides no other warranties for this PRODUCT. The warranty exclusively describes all of the manufacturer’s responsibilities regarding the PRODUCT. There are no other express warranties. No one is authorized to make modifications to this limited warranty and you should not rely on any such modification.

State/Provincial Law rights: This warranty gives you specific legal rights, and you may also have other rights which vary from state to state or province to province.

Limitations: Implied warranties, including those of fitness for a particular purpose and merchantability (an unwritten warranty that the PRODUCT is fit for ordinary use) are limited to one year from date of purchase. Some states/provinces do not allow limitations on how long an implied warranty lasts, so the above limitation may not apply to you. In no event shall the manufacturer be liable for any indirect, special, incidental, consequential, or similar damages (including, but not limited to lost profits or revenue, inability to use the PRODUCT or other associated equipment, the cost of substitute equipment, and claims by third parties) resulting from the use of this PRODUCT. Some states/provinces do not allow the exclusion or limitation of incidental or consequential damages, so the above limitation or exclusion may not apply to you.

Please retain your original sales receipt as proof of purchase.

Technical specifications

RF frequency band	1921.536MHz — 1928.448MHz
Channels	5
Operating temperature	32°F — 122°F 0°C — 50°C
Nominal effective range	500 ft. (indoor) 980 ft. (outdoor)
Battery pack	BT185742/BT285742 2.4V 600mAh Ni-MH
Charger voltage (DC adapter output)	6VDC @ 400mA
Operating times*	Talk time: up to five hours Standby: up to seven days

*Operating time varies depending on your actual use and the age of battery.

DECT 6.0 digital technology

Digital Enhanced Cordless Telecommunications (DECT) 6.0 is a new frequency band that transmits your voice across multiple channels. This technology provides superior quality of voice and sound, high protection against wiretapping and better range than 2.4 GHz and 5.8 GHz phone systems, while not interfering with wireless routers.

Operating range

This cordless speakerphone operates within the maximum power allowed by the Federal Communications Commission (FCC). Even so, this speakerphone and base can communicate over only a certain distance — which can vary with the locations of the base and speakerphone, the weather, and the construction of your home or office.

Simulated full-duplex speakerphone

The simulated full-duplex speakerphone on your speakerphone allows both ends of a call to speak and be heard at the same time. Optimal performance is subject to external factors and individual usage.

Technical specifications

Extended range and clarity

Experience the best in long-range coverage and clarity, provided by a unique antenna design and advances in noise-filtering technology. The TL80133 is a fully cordless DECT 6.0 speakerphone offering a range of up to 500 feet. Open range test was performed by Wyle Laboratories, an independent commercial test facility. "Up to 500 feet" cordless speakerphone range refers to the maximum open field range. Actual range may vary depending on intervening obstacles. Sound level protection conforms to the current regulations and is used to filter out the loud and high-pitched noises.

Index

A

- Alert tones 11
- Answer a call 13
- Auto-off 13, 14, 19, 20

B

- Battery
 - charging 4
 - installation 3

C

- Call waiting 18
- Charger installation 2

D

- Deregister all
 - speakerphones 8

E

- End a call 13

F

- Flash 18

I

- Intercom 20–21

J

- Join a call in progress 19

L

- Light 10
- Limited warranty 41–44
- Listening volume 17

M

- Maintenance 34
- Make a call 13
- Mute 17

O

- Operations 13–21
- Options while on calls 17–19

P

- Paging 16

Q

- Quick reference guide 9–12

R

- Register a speakerphone 5–7
- Replace a speakerphone 8
- Ringer 15

S

- Safety information 30–33
- Specifications 45–46

Index

T

Technical specifications 45–46

Temporary ringer silencing 15

Troubleshooting 22–29

V

Voice command 13

Voice prompts 12

Volume control 17

 listening volume 17

 ringer 15

W

Warranty 41–44



www.telephones.att.com

© 2014 Advanced American Telephones. All Rights Reserved.
AT&T and the AT&T logo are trademarks of AT&T Intellectual Property licensed to
Advanced American Telephones, San Antonio, TX 78219.
Printed in China. Issue 2.0 AT&T 03/14.